

# Standex Mega Profile system

- for exhibition stands with a strong visual presence

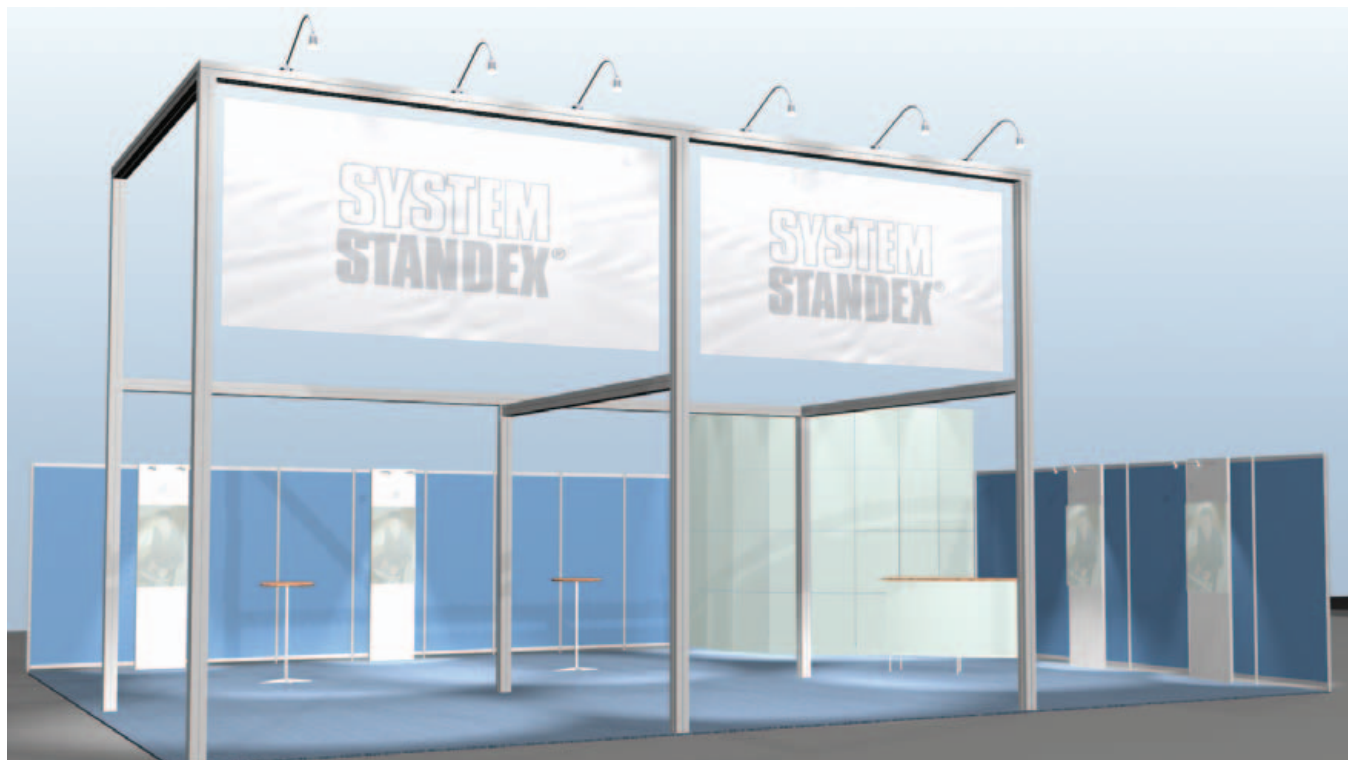

**RC120-4**  
Aluminium profile

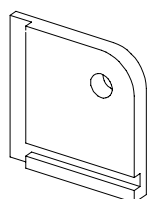
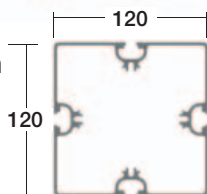

**WS-120-1**  
1 pair of corner plates

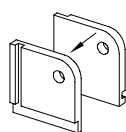

**WS-120-2**  
Complete wire with turnbuckle

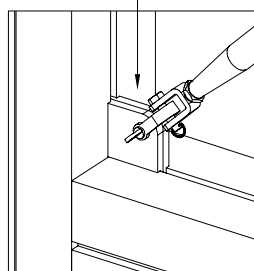

## Joints

Mega Profiles can be assembled anywhere on the side of the profile. Joints are made with connectors that have been developed especially for this system. A PC120-1 connector is slid into the profile, and a hole is drilled so that a joint link can be attached with a wedge bolt.

## Accessories

The profile groove in Mega Profil RC120-4 can be used for fitting of plates or for accessories for mounting of banners and other equipment. System Standex offers standardized solutions for various specific tasks. Do not hesitate to contact us, if you wish to find the best solution for your task.

**D120-6**  
End cap

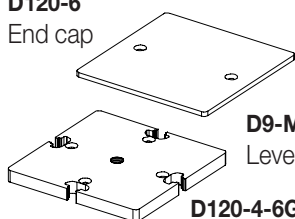

**D9-M10**  
Levelling foot M10

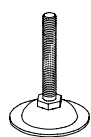

**D120-4-6G/M10**  
Bottomplate with thread

**BAN-120-1**  
Elasticband with hook

**R15-1**  
Aluminium tube Ø15 mm

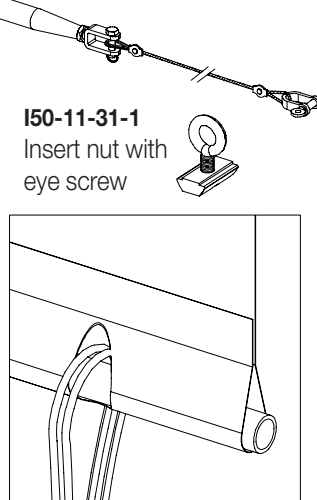

**I50-11-31-1**  
Insert nut with eye screw

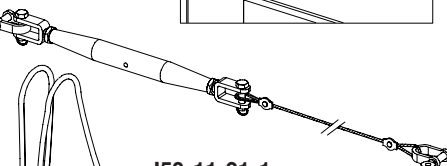

**PC120-1**  
Connector

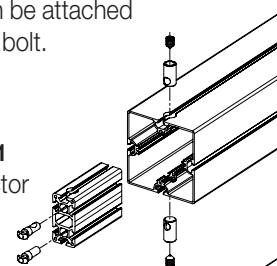

**PC120-2**  
Connector

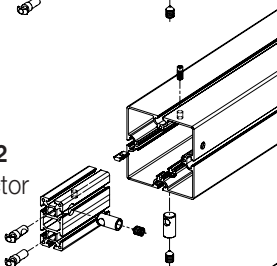

**PC120-3**  
Connector

